

Department of Engineering
Tim Bryan, P.E., PTOE, County Engineer

3137 South Liberty Street, Canton, MS 39046
Office (601) 855-5582 FAX (601) 859-5857

MEMORANDUM

March 13, 2025

To: Casey Brannon, Supervisor, District I
Trey Baxter, Supervisor, District II
Gerald Steen, Supervisor, District III
Karl Banks, Supervisor, District IV
Paul Griffin, Supervisor, District V

From: Tim Bryan, P.E., PTOE
County Engineer

Re: Comcast Utility Permit
County Road Name, Porter Ridge Drive

The Engineering Department recommends approval for Comcast to bore 963' of new underground along cable along Porter Ridge Drive, on both sides of the road.



PERMIT APPLICATION FOR THE CONSTRUCTION OR ADJUSTMENT OF A UTILITY WITHIN COUNTY ROAD RIGHT-OF-WAY

Utility Information: Utility Name: COMCAST COMMUNICATIONS

Address: 118 PORTER RIDGE DR City/State/Zip: CANTON, MS 39046

Contact Person: TANNER ANZ Contact's Phone: 801-989-8726

Project Information: County Road Name: PORTER RIDGE DR
(If located within more than one road right-of-way, use Appendix 1 for additional descriptions)

Beginning Location: 32.516228 -90.043885 Ending Location: 32.516069, -90.044458

Length of Project: 963' Section: 25 Township: 8N Range: 2E

Description of Work: COMCAST IS PROPOSING TO START AT EXT PEDESTAL AND BORING 963' OF NEW UNDERGROUND ALONG PORTER RIDGE DR, ON BOTH SIDES OF THE ROAD. PLEASE SEE ATTACHED PRINTS FOR EXACT LOCATIONS.

Check Box if Appendix 1 is to be included as a part of this Application

Whereas the above stated Utility makes application to the **Madison County Board of Supervisors** for a Construction Permit. Attached hereto are drawings and plans for the construction of the above facilities located within Madison County owned public rights-of-way. Once stamped by the Madison County Engineering Department, these plans shall not be changed or altered without written approval of the County Engineer, or his representative. A copy of the approved permit and plans shall be on-site at all times during construction.

The Applicant Utility shall comply with all policies, procedures and construction practices as outlined in *A Policy for The Accommodation of Utility Facilities within the Right-of-Way of all Public County Roads* (hereinafter referred to as the "Policy"), as adopted on November 1, 2005, by the **Madison County Board of Supervisors**, and which is hereby made a part of this Application Agreement.

If facilities are to be located within the Rights-of-Way of the County-Federal or State Aid System, Applicant Utility also agrees to comply with applicable provisions of *S.O.P. No. SA II-2-8, Accommodation of Utilities on Rights-of-Way*, issued by the State Aid Engineer and dated July 1, 2005.

The Applicant Utility understands and agrees that, except as herein granted, no right, title, claim, or easement to said road right-of-way is granted by the issuance of this permit. If this Utility is listed in the general provisions of the Policy, it will be adjusted to comply with same without cost to the County, unless the variance from the Policy has been approved by the granting of the Permit pursuant to this Application.

The Applicant Utility further understands that the Utility's engineering, plant, or other personnel will be responsible for the staking and construction supervision of the work set out above and as shown on the attached plans. If work impacts traffic in any way, the appropriate traffic control shall be installed per the *Manual of Uniform Traffic Control Devices*, Latest Edition.

The Applicant Utility understands that the County Engineer, or his representative, may issue a Stop Work Order at any time if it is deemed that site conditions are not suitable for construction or if any of the requirements of this permit are not being met.

Many County Roads have variable Rights-of-Way and/or no Right-of-Way at all and are maintained under a Prescriptive Easement. It is the sole responsibility of the Applicant Utility to verify the existence and limits of public rights-of-way. If none exists, it is the

responsibility of the Applicant Utility to acquire an easement for their Facilities from the applicable property owner(s). Madison County in no way verifies the limits of Right-of-Way as shown on the permit application.

The Applicant Utility shall be responsible for all future maintenance and repair of the facilities installed under this permit. The Applicant Utility shall make future adjustments to, or relocate, the facilities located within road or highway right-of-way when required for road or highway widening or other road or highway construction at no cost to Madison County. The Applicant Utility shall relocate said utilities within sixty (60) days of notification by County by registered mail, return receipt requested, unless otherwise designated by the County Engineer. Further, any maintenance, repair, or construction shall be done in such a manner as to occasion no unreasonable interference with the normal flow and safety to traffic and at the expense of the utility company. When reasonable care has been taken to locate said utility facilities within the right-of-way, the Applicant Utility understands that any damages caused by routine maintenance and construction by County forces shall be borne by the Applicant Utility.

The Applicant Utility further agrees to indemnify and hold Madison County harmless for any and all claims, accidents, damages, liabilities and expenses occasioned wholly, or in part, by any act or omission of applicant, its agents or employees. In case County shall, without fault on its own part, be made a party to any litigation commenced by or against applicant, then applicant shall protect and hold County harmless, and shall pay all costs, expenses and reasonable attorney's fees incurred or paid by County in connection with said litigation.

All underground facilities shall be installed at a depth equal to or greater than 48" below the lowest adjacent grade.

All pipes carrying liquid shall be encased under County maintained roads.

WITNESS the signature of the Applicant this the 12nd day of FEBRUARY, 2025.

By: TANNER ANG
(Applicant Signature)

Title: PROJECT MANAGER

Note: Applicant must be an employee of the Utility named in this application. The Madison County Board of Supervisors will not recognize a Contractor, Subcontractor, Agent, or Consulting Engineer as the Applicant. Utility Company shall be fully responsible for all work performed under this application.

I, or my authorized representative, have reviewed this application and determined that the drawing, sketches, and plans submitted by the Applicant meet the requirements of A Policy for The Accommodation of Utility Facilities within the Right-of-Way of all Public County Roads.

APPROVED
By *timothy.bryan at 8:20 pm, Mar 14, 2025*
Tim Bryan, P.E.
County Engineer

AGREED TO AND APPROVED BY:

Madison County Board President

Date: _____

ENTERED INTO THE MINUTES OF THE BOARD OF SUPERVISORS OF MADISON COUNTY, MISSISSIPPI ON THIS _____ DAY OF _____, 20_____.

Appendix 1

County Road Name: _____

Beginning Location: _____ Ending Location: _____

Length of Project: _____ Section: _____ Township: _____ Range: _____

Description of Work: _____

County Road Name: _____

Beginning Location: _____ Ending Location: _____

Length of Project: _____ Section: _____ Township: _____ Range: _____

Description of Work: _____

County Road Name: _____

Beginning Location: _____ Ending Location: _____

Length of Project: _____ Section: _____ Township: _____ Range: _____

Description of Work: _____

County Road Name: _____

Beginning Location: _____ Ending Location: _____

Length of Project: _____ Section: _____ Township: _____ Range: _____

Description of Work: _____

County Road Name: _____

Beginning Location: _____ Ending Location: _____

Length of Project: _____ Section: _____ Township: _____ Range: _____

Description of Work: _____



PREPARED BY:
 NWA COMMUNICATIONS
 5553 HWY 145
 SHANNON, MS 38868
 LANE WATTS / 662-687-1044
 lwatts@nwautilities.com
 permits@nwautilities.com

SUBMITTED ON BEHALF OF:
 COMCAST COMMUNICATIONS
 121 MARKETRIDGE DR RIDGELAND, MS 39517
 TANNER ANZ / 801-989-8726
 tanner_anz@comcast.com

ENGINEERED BY:
 PERMITS@NWAUTILITIES.COM



ENGINEERED FOR:

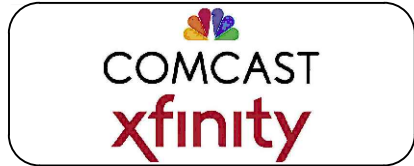

DISCLAIMER

THESE DRAWINGS AND SPECIFICATIONS
 BEING ISSUED IN STRICT
 CONFIDENCE AND SHALL NOT BE
 REPRODUCED,
 COPIED, OR USED FOR ANY PURPOSE
 WITHOUT SPECIFIC WRITTEN PERMISSION

PROJECT TOTAL FOOTAGES

NEW AERIAL BUILD
 0'
 NEW OVERLASH
 0'
 NEW BURIED
 963'



MATERIAL LIST

DESCRIPTION	QUANTITY

PROJECT IDENTIFICATION

JOB #: JB0002102829
 PROJECT NAME:
 MSMAPRD118-UG-MADISON COUNTY
 ADDRESS, CITY, STATE, ZIP
 118 PORTER RIDGE DR CANTON MS 39046
 COUNTY:
 MADISON

LEGEND

LINE TYPES

	UG	PROPOSED UNDERGROUND
	A	PROPOSED AERIAL
	EC	EXISTING CONDUIT
	UE	UTILITY EASEMENT
		EDGE OF TRAVEL
		CENTERLINE
		SURVEY CENTERLINE
		RIGHT OF WAY
		DRIVEWAY
		FENCE LINE
	PL	PROPERTY LINE
		SIDEWALK
		RAILROAD
	W	WATER
	S	SEWER
	G	GAS
	SD	STORM DRAIN
	T	TELECOMMUNICATIONS
	P	POWER
	UNK	UNKNOWN UTILITY

ABBREVIATIONS

EOP	EDGE OF PAVEMENT
R/W	RIGHT OF WAY
R	RISER
SD	STORM DRAIN
S/W	SIDEWALK
HDPE	HIGH DENSITY POLYETHYLENE
STA.	STATION NUMBER
TELCO	TELECOMMUNICATIONS
HH	HANDHOLE
D/W	DRIVEWAY
CONC.	CONCRETE
F/O	FIBER OPTIC
EC	EXISTING CONDUIT

SYMBOLS

	PROPOSED PEDESTAL WITH SILT FENCE		BRIDGE RAIL		ADA RAMP
	PROPOSED VAULT WITH SILT FENCE		PROPOSED ANCHOR		NORTH ARROW
	PROPOSED BOREHOLE WITH SILT FENCE		EXISTING ANCHOR		FIRE HYDRANT
	EXISTING PEDESTAL		STORM DRAIN SYMBOLS		
	EXISTING VAULT		STORM DRAIN SYMBOLS		
	EXISTING TRANSFORMER				
	EXISTING TELECOMMUNICATIONS				
	EXISTING POWER POLE				
	EXISTING MANHOLE				
	WATER VAULT				
	RISER				
	FIBER STORAGE LOOP				

ENGINEERED BY:
PERMITS@NWAUTILITIES.COM



ENGINEERED FOR:



DISCLAIMER

THESE DRAWINGS AND SPECIFICATIONS
BEING ISSUED IN STRICT
CONFIDENCE AND SHALL NOT BE
REPRODUCED,
COPIED, OR USED FOR ANY PURPOSE
WITHOUT SPECIFIC WRITTEN PERMISSION

PROJECT TOTAL FOOTAGES

NEW AERIAL BUILD
0'

NEW OVERLASH
0'

NEW BURIED
963'



MATERIAL LIST

DESCRIPTION	QUANTITY

PROJECT IDENTIFICATION

JOB #: JB0002102829

PROJECT NAME:

MSMAPRD118-UG-MADISON COUNTY
ADDRESS, CITY, STATE, ZIP
118 PORTER RIDGE DR CANTON MS 39046

COUNTY:
MADISON

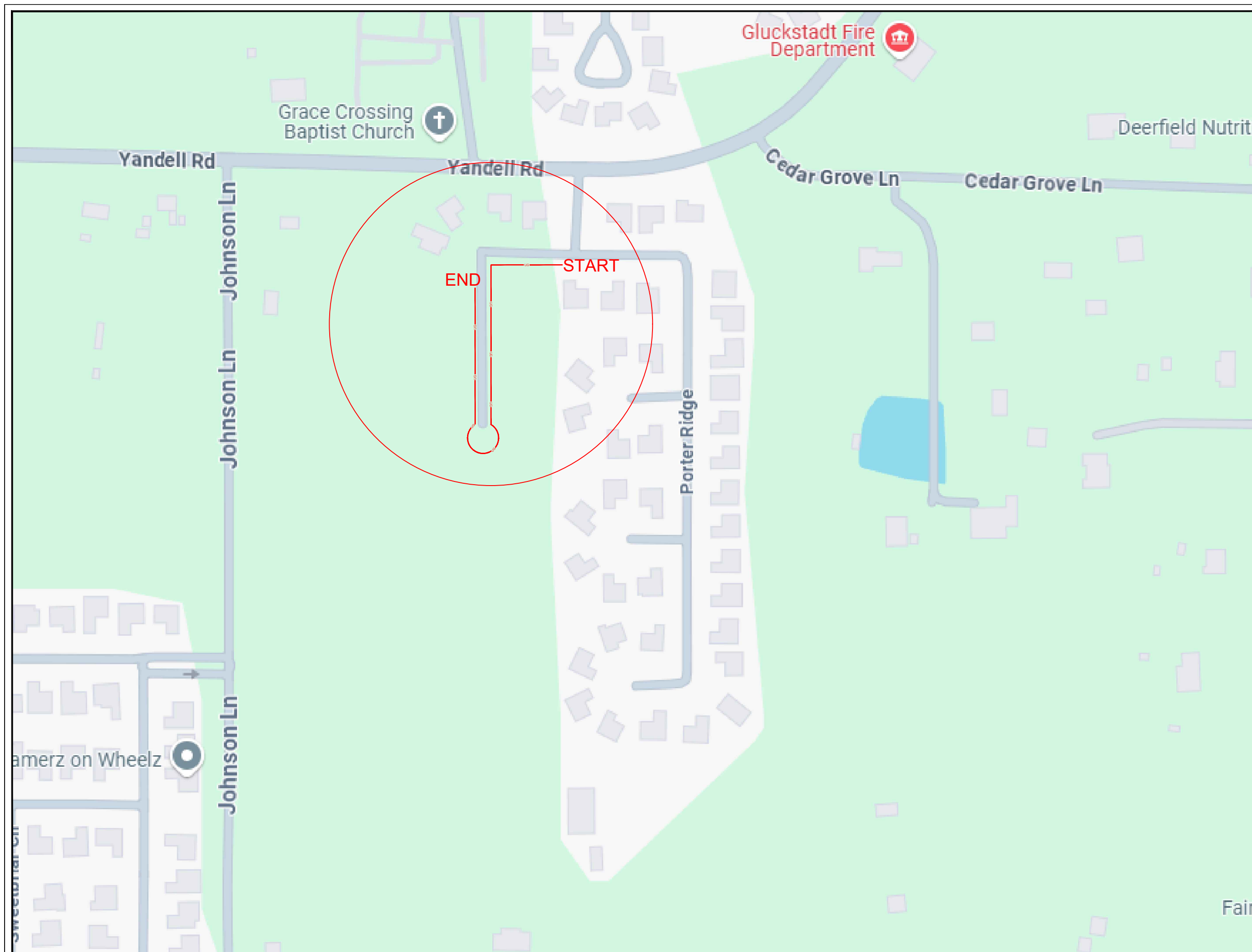

ENGINEERED BY:
PERMITS@NWAUTILITIES.COM



ENGINEERED FOR:



DISCLAIMER

THESE DRAWINGS AND SPECIFICATIONS BEING ISSUED IN STRICT CONFIDENCE AND SHALL NOT BE REPRODUCED, COPIED, OR USED FOR ANY PURPOSE WITHOUT SPECIFIC WRITTEN PERMISSION

PROJECT TOTAL FOOTAGES

NEW AERIAL BUILD
0'
NEW OVERLASH
0'
NEW BURIED
963'



MATERIAL LIST

DESCRIPTION	QUANTITY

PROJECT IDENTIFICATION

JOB #: JB0002102829

PROJECT NAME:

MSMAPRD118-UG-MADISON COUNTY
ADDRESS, CITY, STATE, ZIP
118 PORTER RIDGE DR CANTON MS 39046

COUNTY:
MADISON

112

PROPOSED PEDESTAL
RT 30'
32.516214° -90.044292°

PROPOSED PEDESTAL
LT 30'
32.516069° -90.044458°

PROPOSED PEDESTAL
LT 30'
32.515827° -90.044460°

PROPOSED PEDESTAL
LT 30'
32.515375° -90.044465°

BORE HOLE
LT 30'
3'Wx3'Lx5'D
32.516230° -90.044114°

BORE HOLE
LT 30'
3'Wx3'Lx5'D
32.516228° -90.043894°

EXISTING PEDESTAL
RT 30'
32.516228° -90.043885°

PROPOSED COMCAST UNDERGROUND
DIRECTIONAL BORE
ONE 2" HDPE CONDUIT
5' MIN DEPTHS ALL POINTS

PROPOSED PEDESTAL
RT 30'
32.515736° -90.044294°

PROPOSED PEDESTAL
RT 30'
32.515326° -90.044266°

PROPOSED PEDESTAL
RT 30'
32.515102° -90.044399°

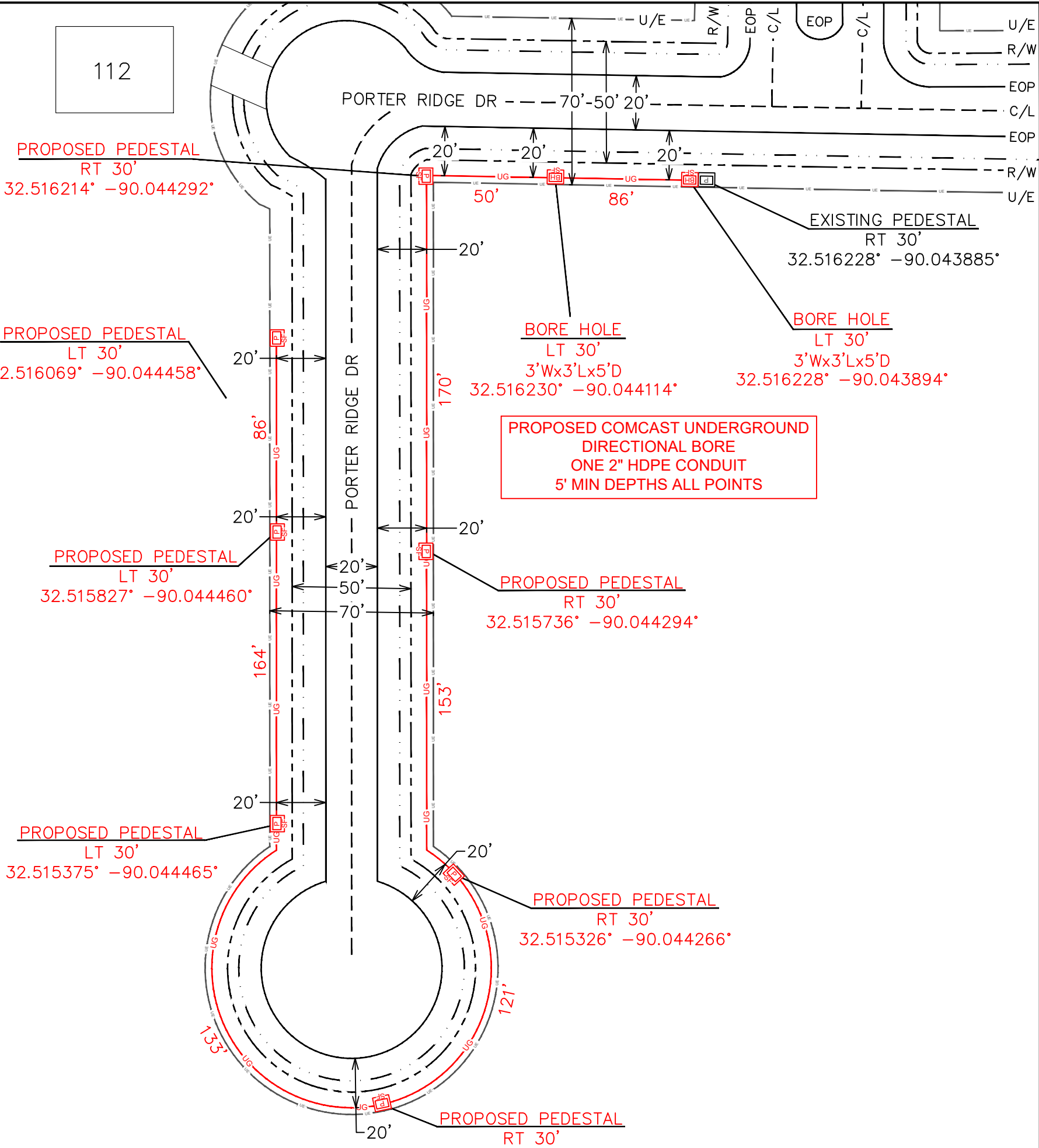

ENGINEERED BY:
PERMITS@NWAUTILITIES.COM

NWA
COMMUNICATIONS

ENGINEERED FOR:

COMCAST
xfinity

811 Know what's below.
811 before you dig.

DISCLAIMER
THESE DRAWINGS AND SPECIFICATIONS BEING ISSUED IN STRICT CONFIDENCE AND SHALL NOT BE REPRODUCED, COPIED, OR USED FOR ANY PURPOSE WITHOUT SPECIFIC WRITTEN PERMISSION

PROJECT TOTAL FOOTAGES	
NEW AERIAL BUILD	0'
NEW OVERLASH	0'
NEW BURIED	963'



MATERIAL LIST	
DESCRIPTION	QUANTITY

PROJECT IDENTIFICATION

JOB #: JB0002102829

PROJECT NAME:
MSMAPRD118-UG-MADISON COUNTY
ADDRESS, CITY, STATE, ZIP
118 PORTER RIDGE DR CANTON MS 39046

COUNTY:
MADISON



ENGINEERED FOR:



DISCLAIMER

THESE DRAWINGS AND SPECIFICATIONS BEING ISSUED IN STRICT CONFIDENCE AND SHALL NOT BE REPRODUCED, COPIED, OR USED FOR ANY PURPOSE WITHOUT SPECIFIC WRITTEN PERMISSION

PROJECT TOTAL FOOTAGES

NEW AERIAL BUILD	0'
NEW OVERLASH	0'
NEW BURIED	963'



MATERIAL LIST

DESCRIPTION	QUANTITY

PROJECT IDENTIFICATION

JOB #: JB0002102829

PROJECT NAME:
MSMAPRD118-UG-MADISON COUNTY
ADDRESS, CITY, STATE, ZIP
118 PORTER RIDGE DR CANTON MS 39046

COUNTY:
MADISON

STATE HWY
TYPICAL AERIAL
HEIGHT

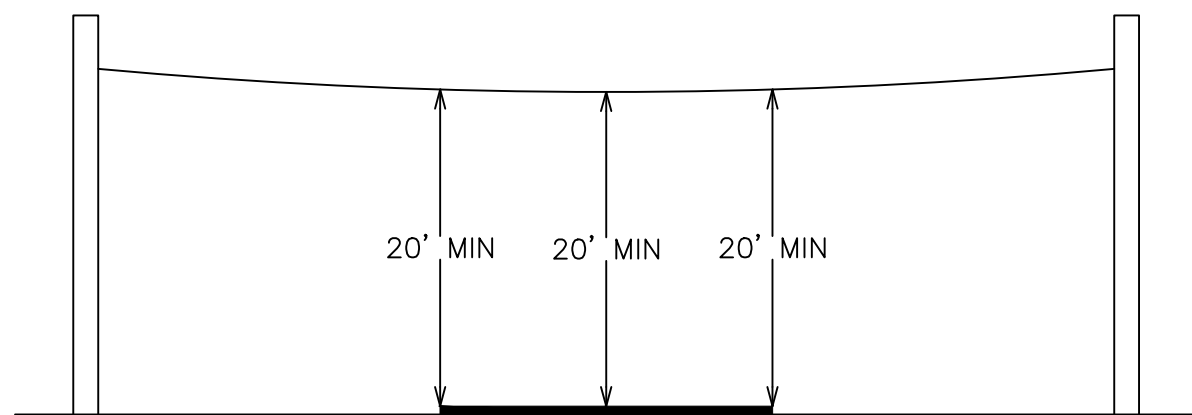

INTERSTATE
TYPICAL AERIAL
HEIGHT

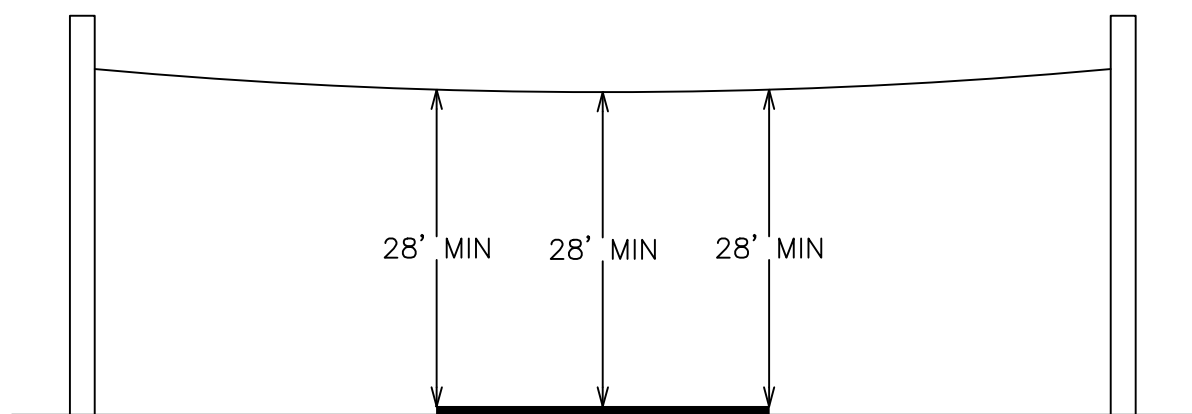

TYPICAL UNDERGROUND
DEPTH

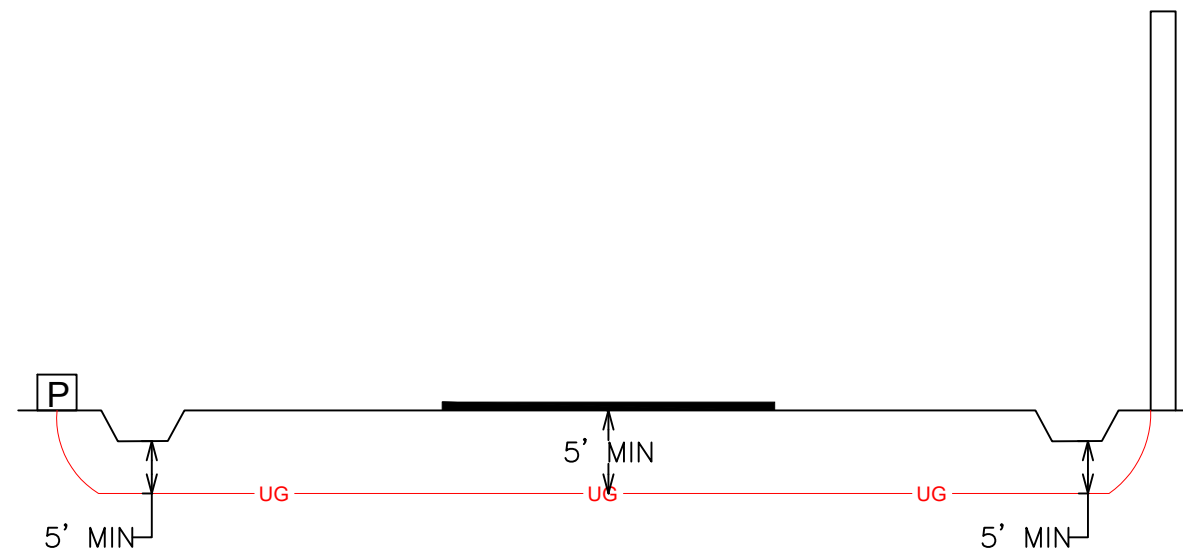



ENGINEERED FOR:



DISCLAIMER

THESE DRAWINGS AND SPECIFICATIONS
 BEING ISSUED IN STRICT
 CONFIDENCE AND SHALL NOT BE
 REPRODUCED,
 COPIED, OR USED FOR ANY PURPOSE
 WITHOUT SPECIFIC WRITTEN PERMISSION

PROJECT TOTAL FOOTAGES

- NEW AERIAL BUILD
0'
- NEW OVERLASH
0'
- NEW BURIED
963'



MATERIAL LIST

DESCRIPTION	QUANTITY

PROJECT IDENTIFICATION

JOB #: JB0002102829

PROJECT NAME:

MSMAPRD118-UG-MADISON COUNTY
 ADDRESS, CITY, STATE, ZIP
 118 PORTER RIDGE DR CANTON MS 39046

COUNTY:
 MADISON

